

## MOUNTING INSTRUCTIONS TO INSTALL MINI-CAMERA INTO 4" DOME

1. Using enclosed L-key undo 3 housing screws and remove Dome Cover.
2. Remove the screw and insert from the Mounting Ear opposite the one with the Knob.
3. Remove Knob on the side of the Camera Holder by turning it CCW
4. Note the position of Camera Holder in relationship to Mounting Ears (see Pic.1 shown with camera)

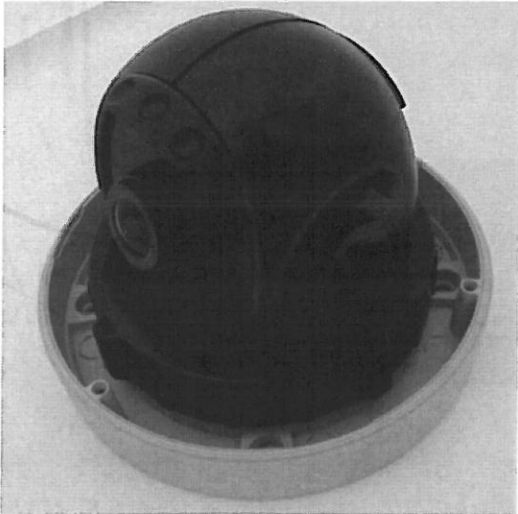

PIC. 1

5. Remove Camera Holder from Mounting Ears by pulling leg of Mounting Ears OPPOSITE to Knob Shaft
6. Remove 2 screws from Camera Holder and split Holder in 2 pieces.
7. Attach enclosed brackets to both sides of the camera as shown (see pic.2) using included  $\frac{1}{4}$ -20 screws. Make sure that edges of both brackets are approximately level with each other. You may want to adjust position of the camera in relationship to bracket later.

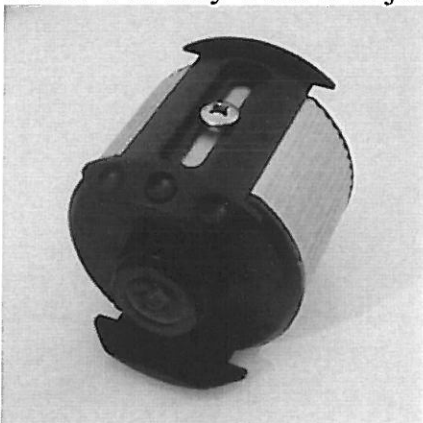

PIC. 2

8. Assemble Camera Holder with camera, using 2 screws from step 6. Make sure that position of Camera Holder in relationship to Mounting Ears is the same as in step 4. Make sure that you are able to turn the camera inside of the Holder, but it's not loose. Tighten "bottom" screw (the one NOT seen on Pic.3). **Do not over-torque screws.**

9. Insert Camera Holder into Mounting Ears “shaft first”. (see Pic.3) Note the leg of Mounting Ears in which shaft is inserted is “straight” vs opposite “trapezoid” (see Pic. 4)
10. Install Knob from step 3 onto the shaft.



PIC. 3



PIC. 4

11. Install insert and screw from step 2
12. Run Ethernet cable from PoE switch thru the center hole of the housing into camera
13. Mount camera on desired surface. (see mounting recommendations below)
14. Focus camera.
15. Rotate the camera inside the Camera Holder if necessary.  
Adjust second screw from step 8. **Do not over-torque screws.**
16. Release Plastic Ring on the bottom and rotate camera as necessary. Tighten the Ring.
17. Release Knob from step 10 and tilt camera as necessary. Tighten the Knob.
18. Focus camera again if necessary.
19. Attach Dome Cover with 3 screws (from step 1)

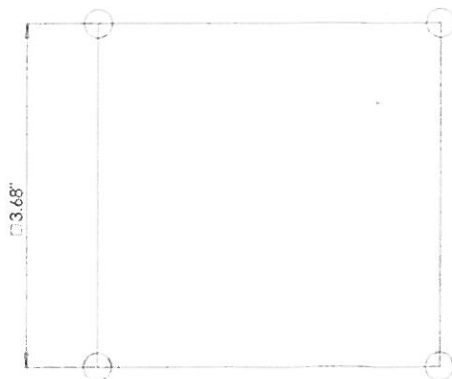

**Use enclosed 4 mounting screws with pattern above.**